

# DRAWER ASSEMBLY

## The Drawers

5) Need: Boards W, V and XX. Parts R and S.

Take board W and screw in four cam screws (S) into the four plastic inserts (fig.8). The cam screws should be placed so that there is an inch of the screw left showing.

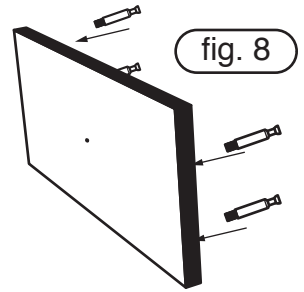

Put board V on the right side of board W, placing the board onto the cam screws there (fig.9). Place a cam lock (R) in each of the two large holes on the side of board V where you can see the cam screws from board W. Turn the cam locks clockwise slowly until they are tight. If the cam locks do not tighten or are unable to turn, check the positioning and length of the cam screws. Repeat this process on the left side.

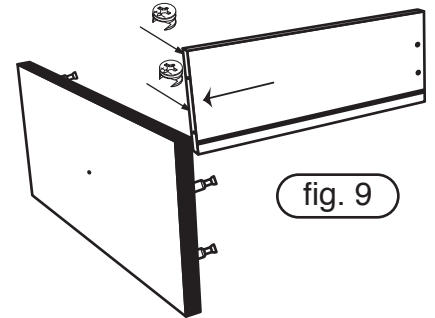

Insert the drawer base (XX) into the grooves of the current assembly (fig.10).

6) Need: Board X and Part T.

Place board X onto the rear of the completed assembly, making sure that the base (XX) fits smoothly. Screw in four long screws (T) into the end of both side boards (V) to attach board X firmly in place (fig.11).

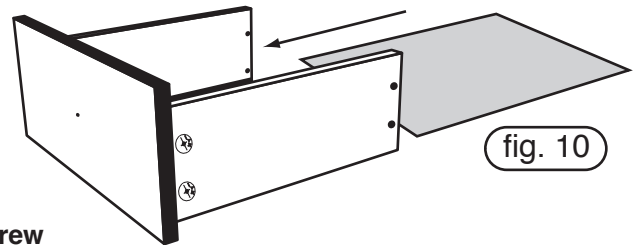

Take the knob (U) and remove the screw inside of it. Insert the screw into the back of the board (Y) then screw the knob (U) onto the screw using a screwdriver to hold the screw firmly while you twist the knob on.

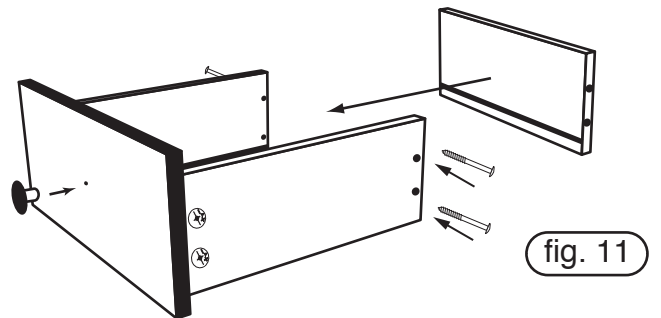

\*Repeat these instructions for the second drawer\*

## DRAWER SLIDES

7) Need: Part Q and E

The drawer slide has 2 parts. Pull the inside of the slide out and set the outer part aside. Starting with the inner part, attach it to the side of the drawer with part E. Make sure that the black latch is toward the back (fig.12).

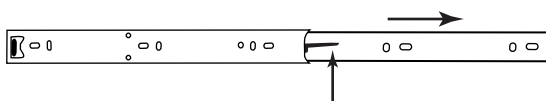

While pushing up the tail of latch, pull inner part completely out.

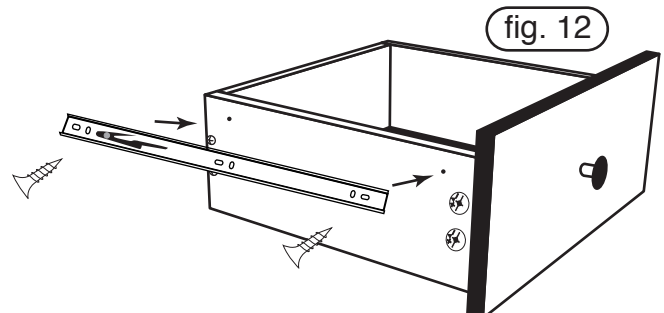
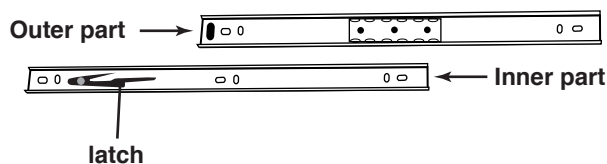

Repeat these steps for all of the slides and drawers.